

Wayland High School Field House – Infield Upgrade

April 15, 2008

MAPLE
HILL
ARCHITECTS

01.18.08

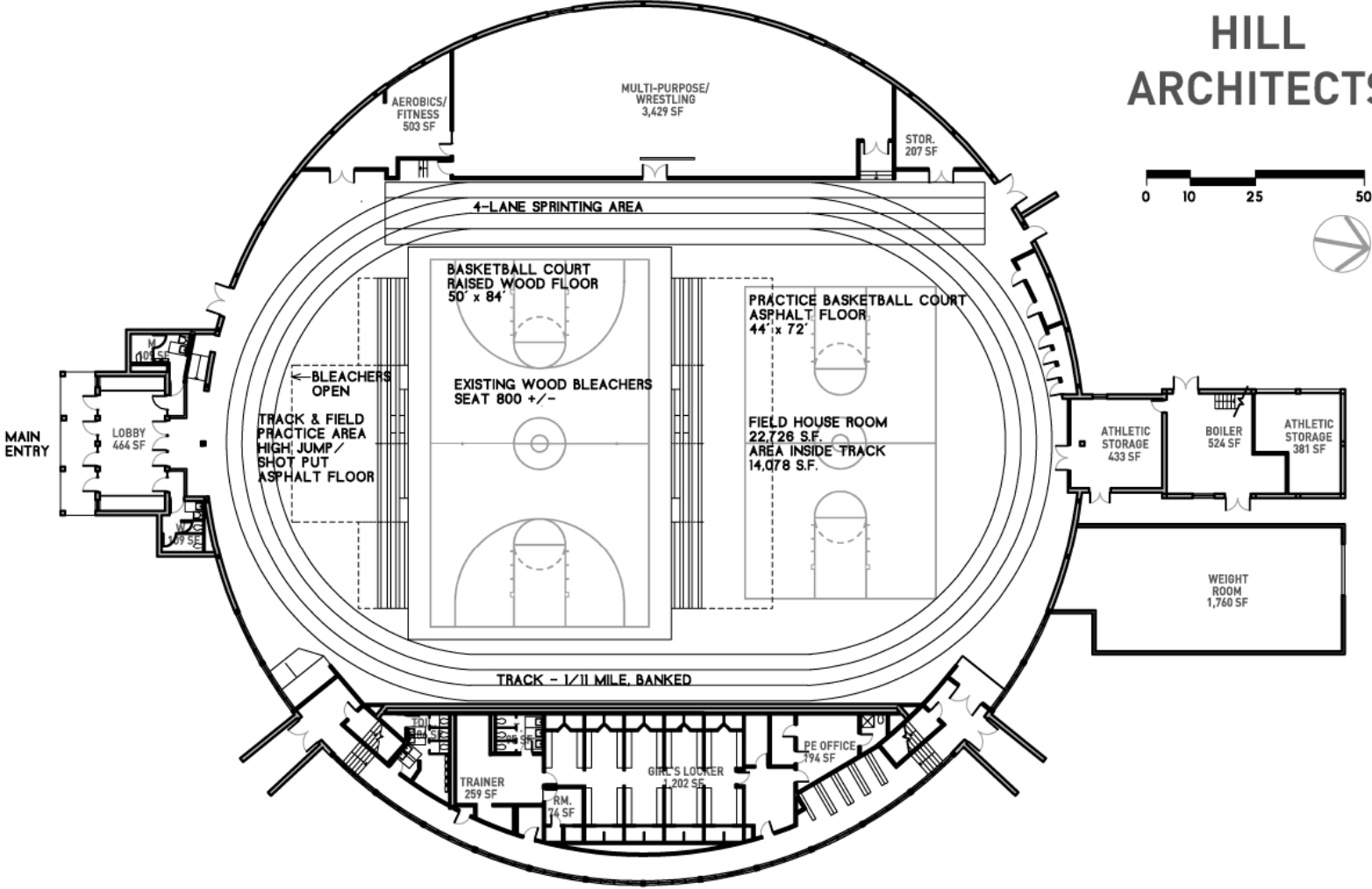

MAIN FLOOR PLAN
WAYLAND HIGH SCHOOL
FIELD HOUSE

EXISTING CONDITIONS

03.07.08

COMP. BASKETBALL

MAPLE
HILL
ARCHITECTS

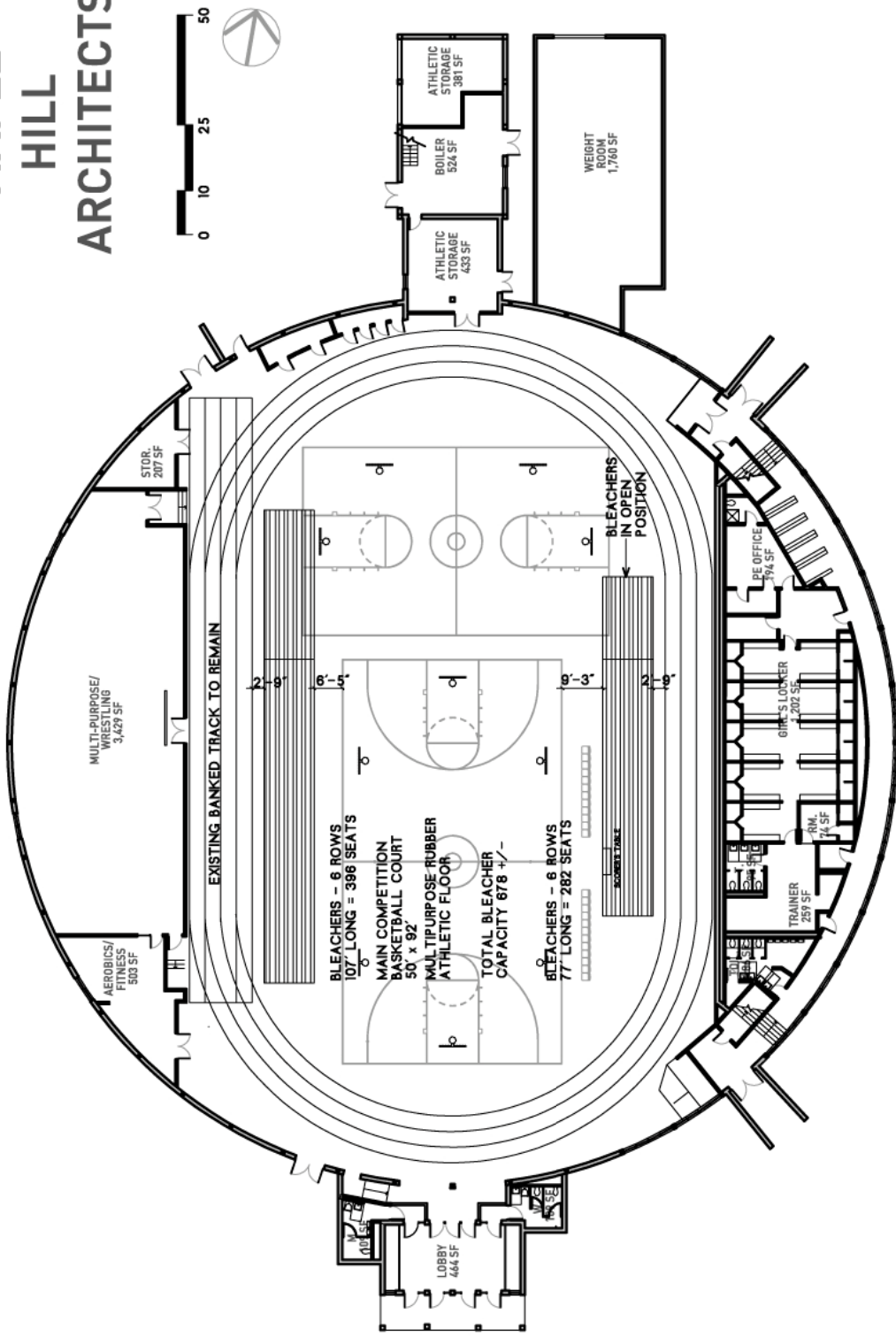

MAIN FLOOR PLAN WAYLAND HIGH SCHOOL FIELD HOUSE

MAPLE
HILL
ARCHITECTS

PRACTICE BASKETBALL

03.07.08

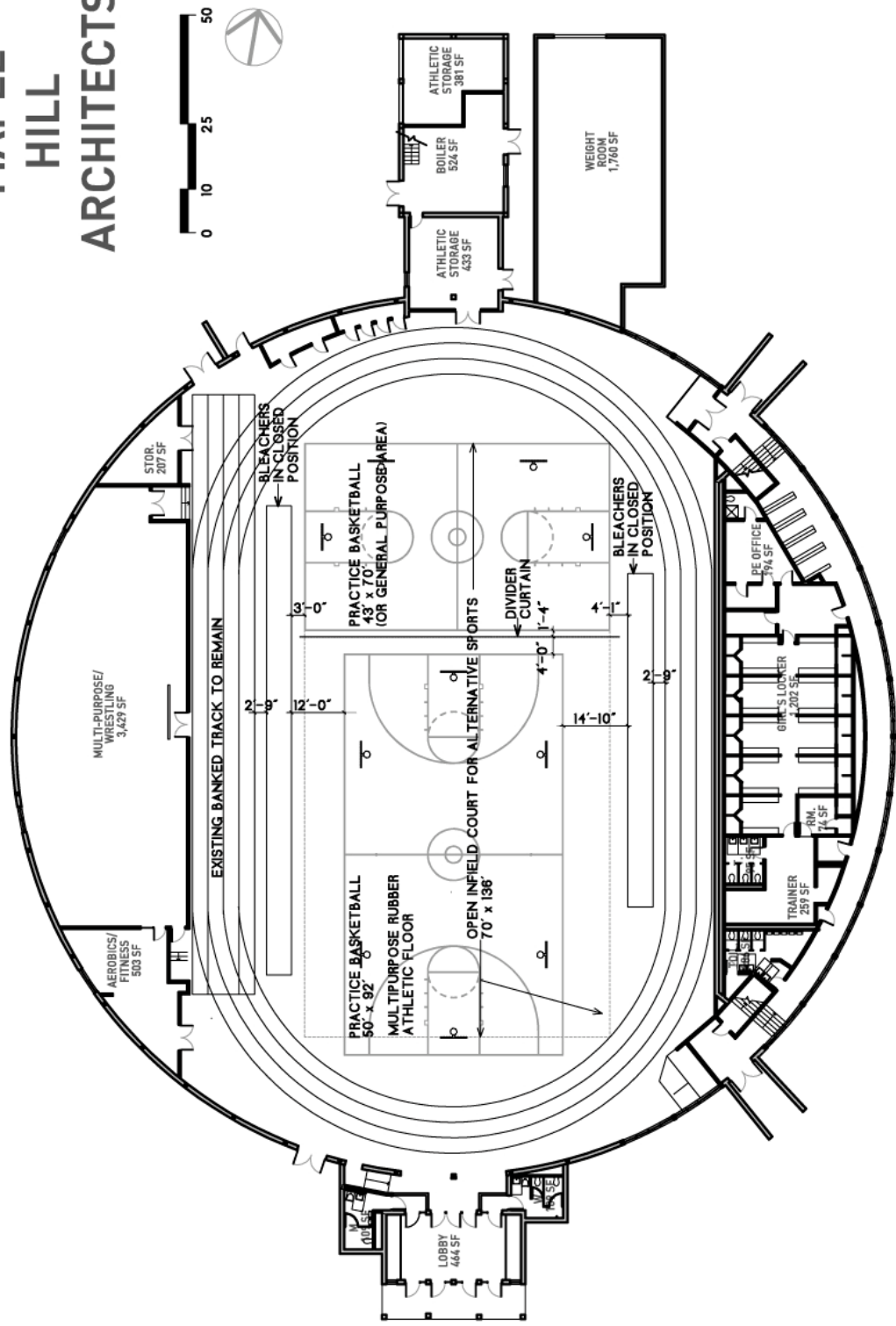

MAIN FLOOR PLAN
WAYLAND HIGH SCHOOL
FIELD HOUSE

03.07.08

MAPLE
HILL
ARCHITECTS

VOLLEYBALL

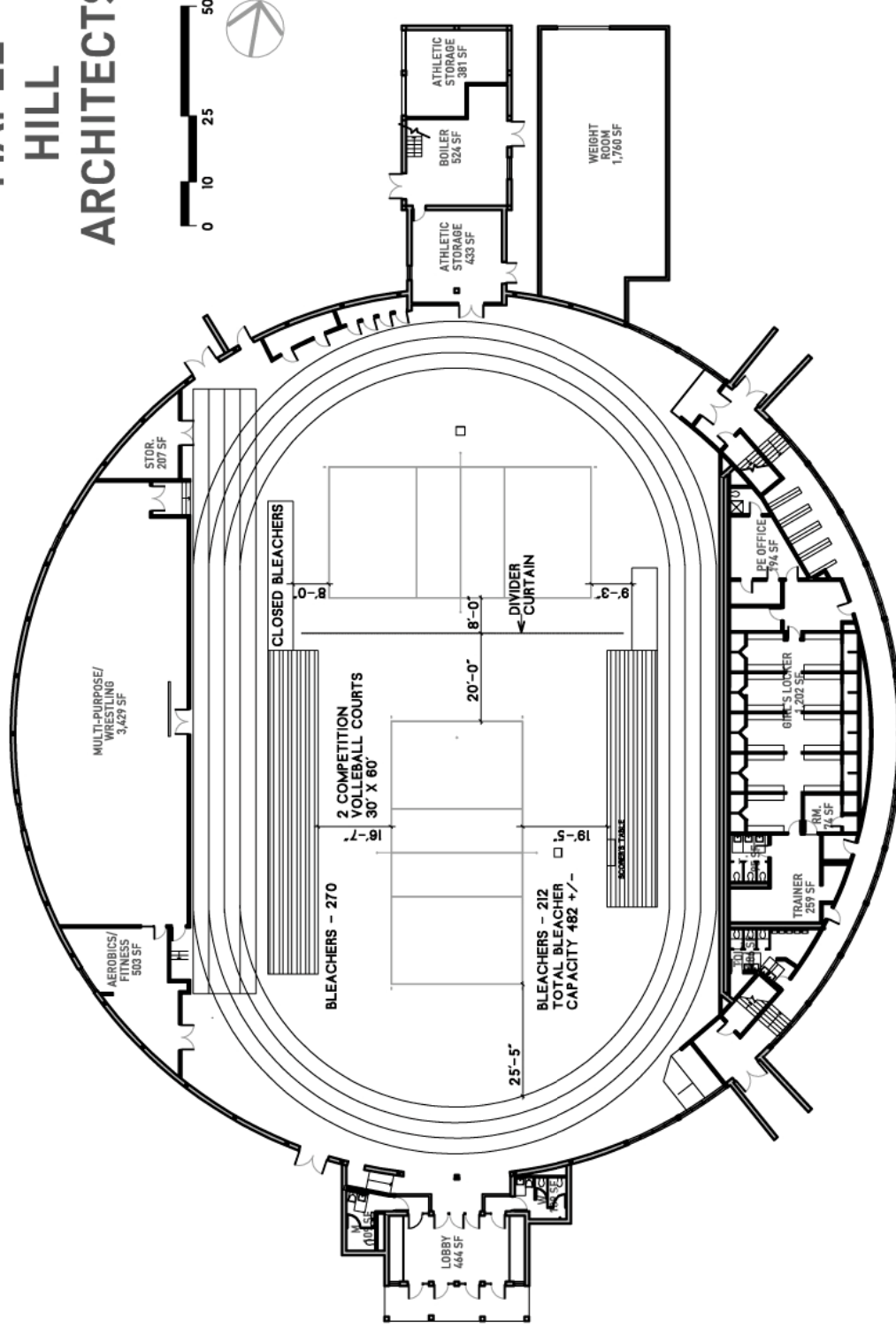

MAIN FLOOR PLAN WAYLAND HIGH SCHOOL FIELD HOUSE

03.05.08

TOWN MEETING SETUP

MAPLE
HILL
ARCHITECTS

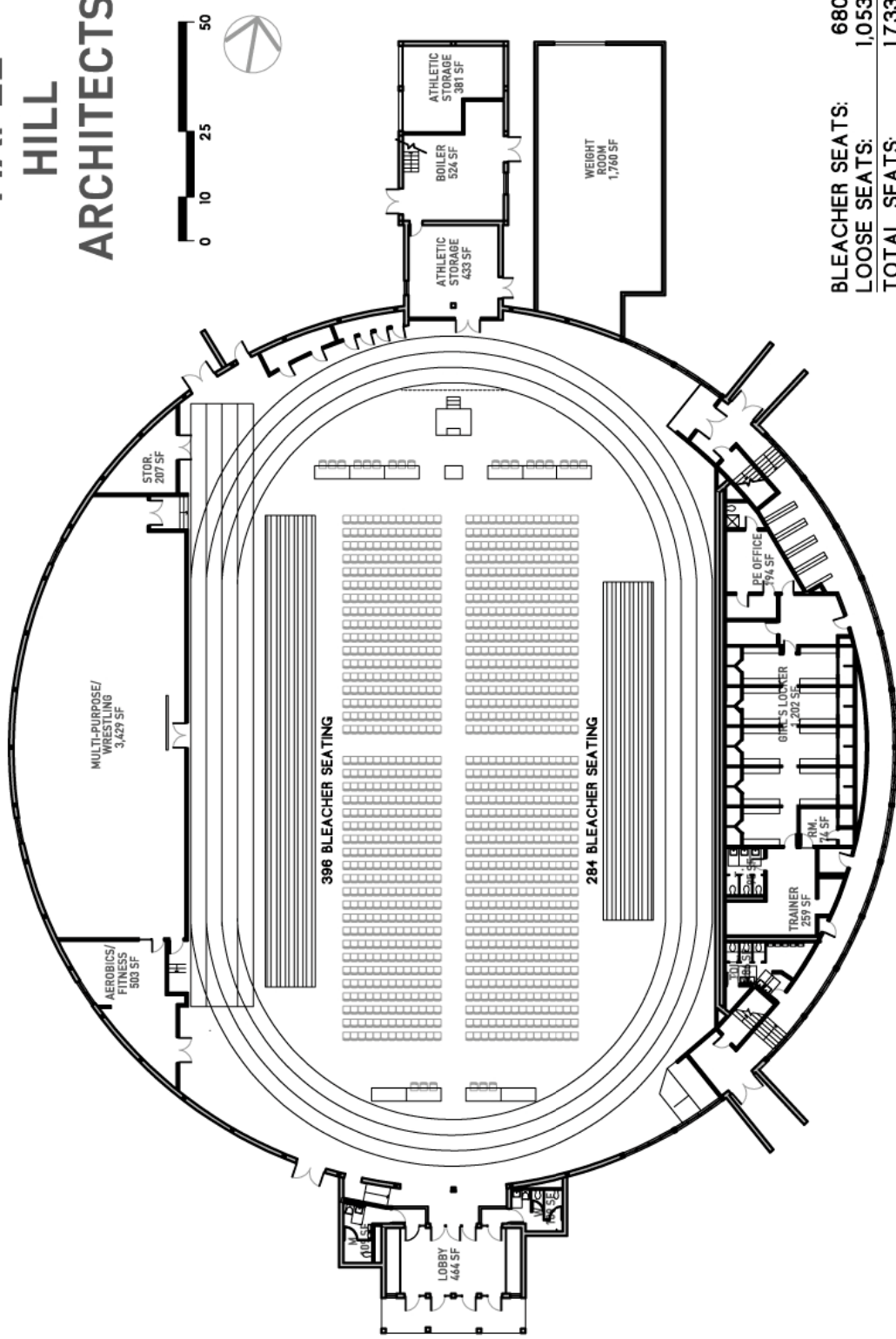

BLEACHER SEATS: 680
 LOOSE SEATS: 1,053
 TOTAL SEATS: 1,733

MAIN FLOOR PLAN WAYLAND HIGH SCHOOL FIELD HOUSE

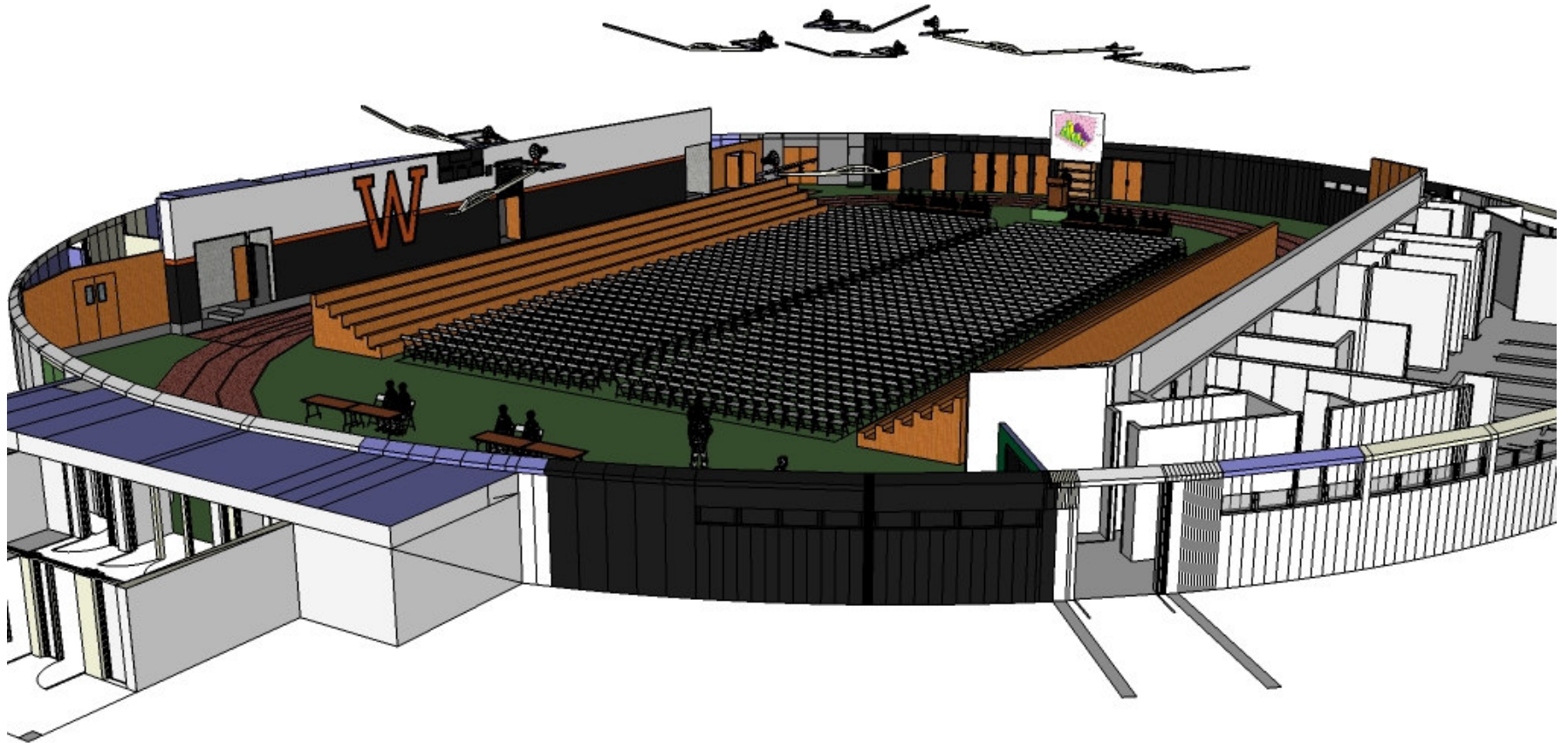

Town Meeting

Thank You